

BHAMBAYI COMMUNITY HALL

Proposal for

PERMACULTURE GARDEN

5 September 2005



Contact : W. Coughlan

Address : P.O. Box 76404, Marbleray, 4035, South Africa

Tel / Fax : +27 31 577 2844, Email : newlandspmaculture@absamail.co.za

1. Introduction

The Bhambayi Community Hall has just been completed except for the site gardens which has a sub-budget of R20,000 reserved from the overall project budget. Following discussions amongst Harber & Associates (HA), Greater Durban Community Foundation (GDCF), Newlands Mashu Permaculture Learning Centre (NMPLC), and, E. Gori & Associates (EGA), an opportunity arose to create a Permaculture agricultural garden with this R20,000 budget. To this end, EGA agreed to undertake this Permaculture design with NMPLC responsible for implementation.

2. Permaculture Site Design

The site plan for the Permaculture site design is shown in Drawing No.1 whilst design details are shown in Drawing No.2. The site plan takes cognizance of the even slope and the opportunity to create rainwater harvesting systems through the establishment of swales, and, a reno mattress combination subsoil drain at the site entrance to absorb the stormwater runoff from the road onto the site. The swales adjacent to the area covered by the shade cloth ought to be slightly off contour and form a crescent next to the fence line for banana pits.

The site plan allows for some 27 trees and 15 banana plants. The area under shade cloth will be used as a nursery for tree seedlings and examples of companion plant guilds. Other design features include a rockery and a “problem solving” spiral.

The Permaculture design provides many examples of low external input sustainable agriculture (LEISA) for local aspiring urban farmers. The Bhambayi Community Hall and its Permaculture Garden is envisaged to become a focal area from which the adjacent community agricultural scheme will be managed..

3. Budget

A detailed budget for R20,000 is shown in Schedule 1. This budget includes the employment of 3 local aspiring farmers for 20 days to help establish the Permaculture Gardens. No budget is provided for ongoing maintenance and the local community will need to make the necessary arrangements.

4. Programme

The programme is shown in Schedule 2 and is expected to take 5 weeks to complete after an initial one week to make the necessary arrangements with the local community; source plant material; and, make any other logistical arrangements.

Drawing No.1 - Site Plan

Drawing No.2 - Site Details

Schedule 1 - Budget

Schedule 2 - Programme

BHAMBAYI COMMUNITY HALL

Drawing No.1 - Site Plan -2005/09/05

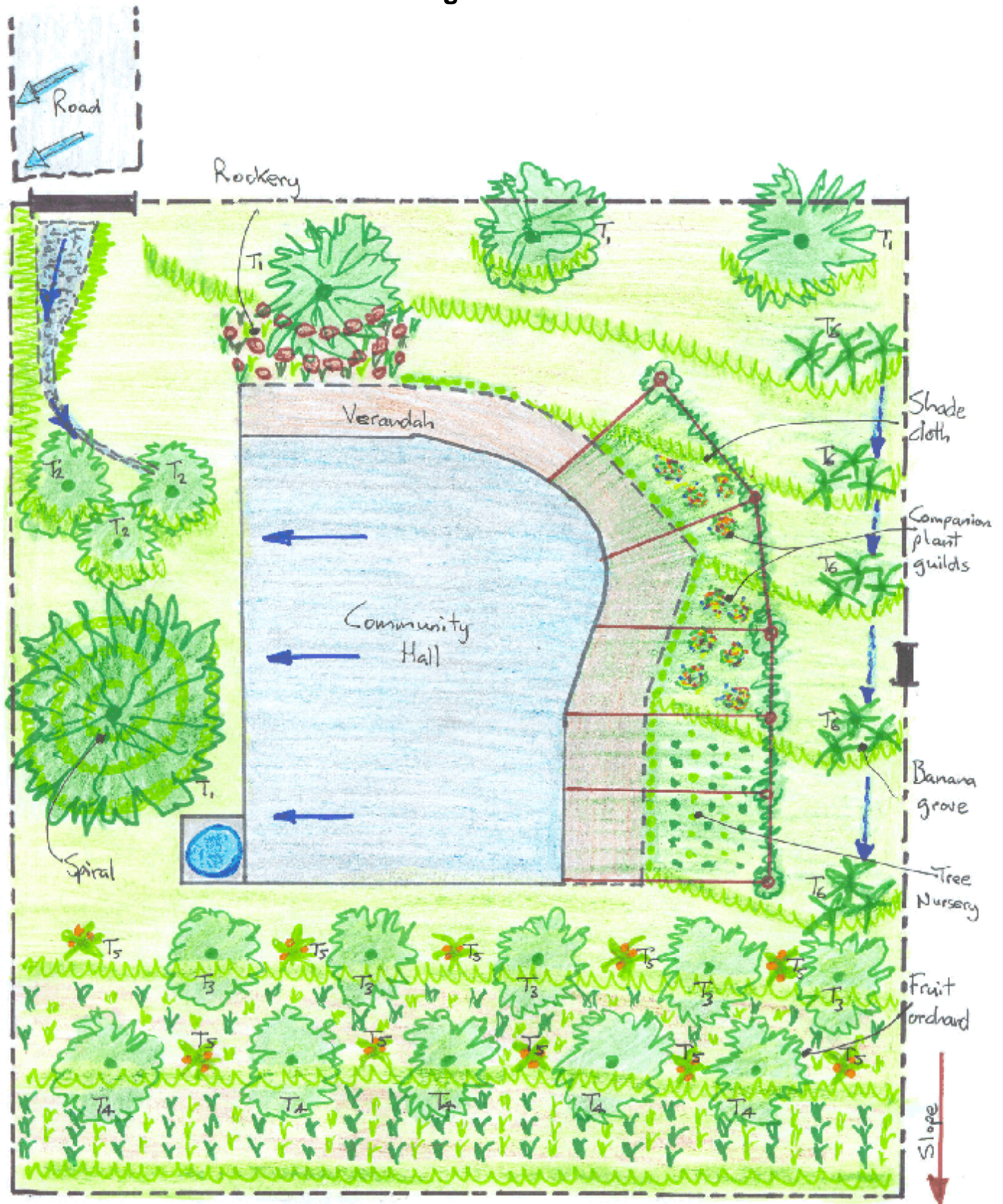

- Legend
- T₁ = Acacia
 - T₂ = Mango
 - T₃ = Avocado
 - T₄ = Litchi
 - T₅ = Pampaw
 - T₆ = Banana

vetiver swales



Scale

BHAMBAYI COMMUNITY HALL
Drawing No.2 - Site Details -2005/09/05

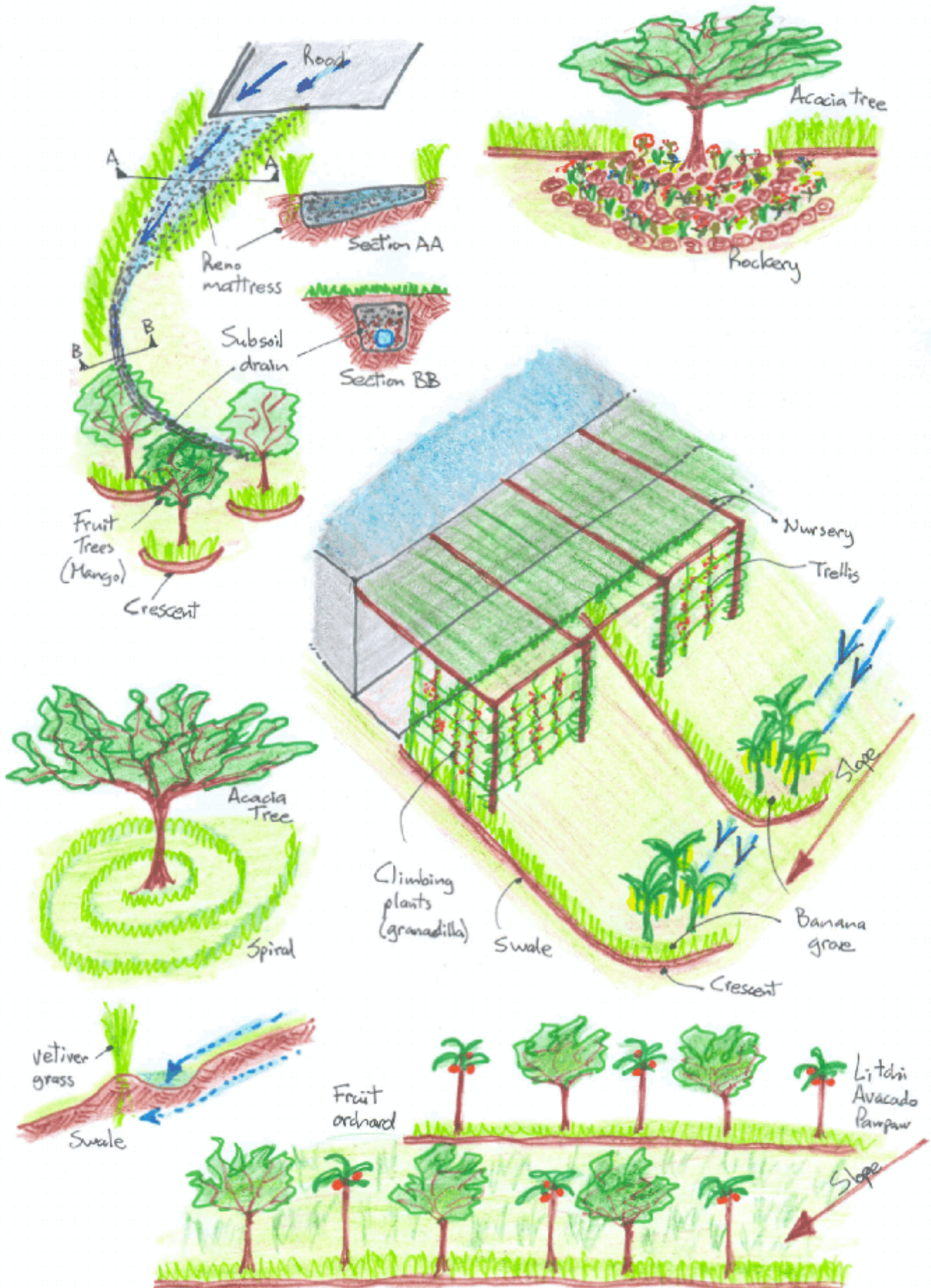

BHAMBAYI COMMUNITY HALL

Schedule 1 - Budget

#	Task	Unit	Quantity	Rate	Amount	
1	Site works				R 5,075	25.4%
1.1	Reno mattress	m2	7	R 150	R 975	
1.2	Subsoil drain	m	7	R 130	R 845	
1.3	Vetiver to swales	m	201	R 15	R 3,015	
1.4	Mulch material	m2	400	R 0.60	R 240	
2	Plant material				R 2,315	11.6%
2.1	Guilds of companion plants	no.	10	R 50	R 500	
2.2	Medicinal plants	sum	1	R 500	R 500	
2.3	Climbing plants (granadilla)	sum	1	R 65	R 65	
2.4	Variety of tree seedlings	no.	50	R 15	R 750	
2.5	Variety of seeds	sum	1	R 500	R 500	
3	Trees				R 490	2.5%
3.1	Acacia	no.	4	R 50	R 200	
3.2	Mango	no.	3	R 10	R 30	
3.3	Avocado	no.	5	R 20	R 100	
3.4	Litchi	no.	5	R 10	R 50	
3.5	Pawpaw	no.	10	R 5	R 50	
3.6	Banana	no.	15	R 4	R 60	
4	Small tools				R 560	2.8%
4.1	Wheel barrow	no.	1	R 180	R 180	
4.2	Spades	no.	2	R 70	R 140	
4.3	Hoes	no.	2	R 70	R 140	
4.4	Hose pipe	sum	1	R 100	R 100	
5	Labour				R 4,200	21.0%
5.1	Local unskilled labour	days	60	R 70	R 4,200	
6	Transport	kms	320	R 3	R 960	4.8%
7	Site supervision				R 4,400	22.0%
7.1	Permaculturist	days	2	R 1,000	R 2,000	
7.2	Assistant Permaculturist	days	8	R 300	R 2,400	
8	Project management	hours	8	R 250	R 2,000	10.0%
Sub-Total					R 20,000	100.0%
VAT (zero%)					R 0	
Total					R 20,000	

BHAMBAYI COMMUNITY HALL

Schedule 2 - Programme

#	Task	Week 1	Week 2	Week 3	Week 4	Week 5
A	Project preparation					
A.1	Selection of local labour					
A.2	Permaculture orientation					
A.3	Acquire small tools & plant material					
B	Site works					
B.1	Reno mattress					
B.2	Subsoil drain					
B.3	Construct swales					
B.4	Mulch beds					
C	Plant material					
C.1	Establish guilds of companion plants					
C.2	Establish medicinal plants					
C.3	Establish climbing plants (granadilla)					
C.4	Plant trees					